

Glass Door Display

GDM-69-HC-LD

Upright Retail Merchandiser Refrigerator, 3 Full Glass Slide Doors



Dimensions	
External Width (mm)	1985
External Depth (mm)	753
External Height (mm)	1998
Net Volume (Litres)	1234
Gross Volume (Litres)	2039
Supplied Shelves	12
Shelf Size (L x D mm)	607 x 523
Internal Net Height (mm)	1300
Unpackaged Weight (kg)	277
Packaged Weight (kg)	307
Packaged Dimensions (W x D x H mm)	2045 x 829 x 2134
Exclusions	Depth does not include 10 mm for door handle or 13 mm for rear access panel.
Display Area (m ²)	2.12
Supplied with	Levelling Screws. Optional castors sold seperately.

Build	
Cord Length (Meters)	2.74
Internal Lighting	LED
Door Description	3 Full Glass Slide Doors
Exterior Construction	Stainless Steel/Aluminium front, Aluminium sides and rear (Black or White Powder Coat option)
Interior Construction	White coated aluminium, stainless steel base
Air Intake Position	Front
Ventilation Position	Rear
Clearance Required	26 mm rear, zero sides
Standard w/ Locks	Not Standard. Options available.

Technical	
Temperature Range	0.5 : 3.3°C
Refrigerant	R290
Voltage/Frequency/Phase	220-240V/50Hz/1
Amps	3.8
Watts	758
Defrost Type	Auto
Climate Class	3
Temperature Class	M1
Operating Statement	Tested at 25°C, 60% RH, per 'Refrigerators with a Direct Sales Function' for perishable food merchandising.
Test Standard	EN ISO 23953-2:2023
EEC	B
Energy Efficiency Index	19.9
Energy Consumption (kWh/24h)	7.138
Energy Consumption (kWh/Annum)	2605



Specifications subject to change without notice.
Chart dimensions rounded up to the next whole millimeter (inches rounded up to the 1/8")

UK & Ireland
EMEA
Australia

0800 783 2049
[+41 61 563 07 05](tel:+41615630705)
[+61 2 9619 9999](tel:+61296199999)

TFIUK@truemfg.com
TrueCHCustomerService@truemfg.com
TrueRefAus@truemfg.com



GDM-69-HC-LD

Upright Retail Merchandiser Refrigerator, 3 Full Glass Slide Doors

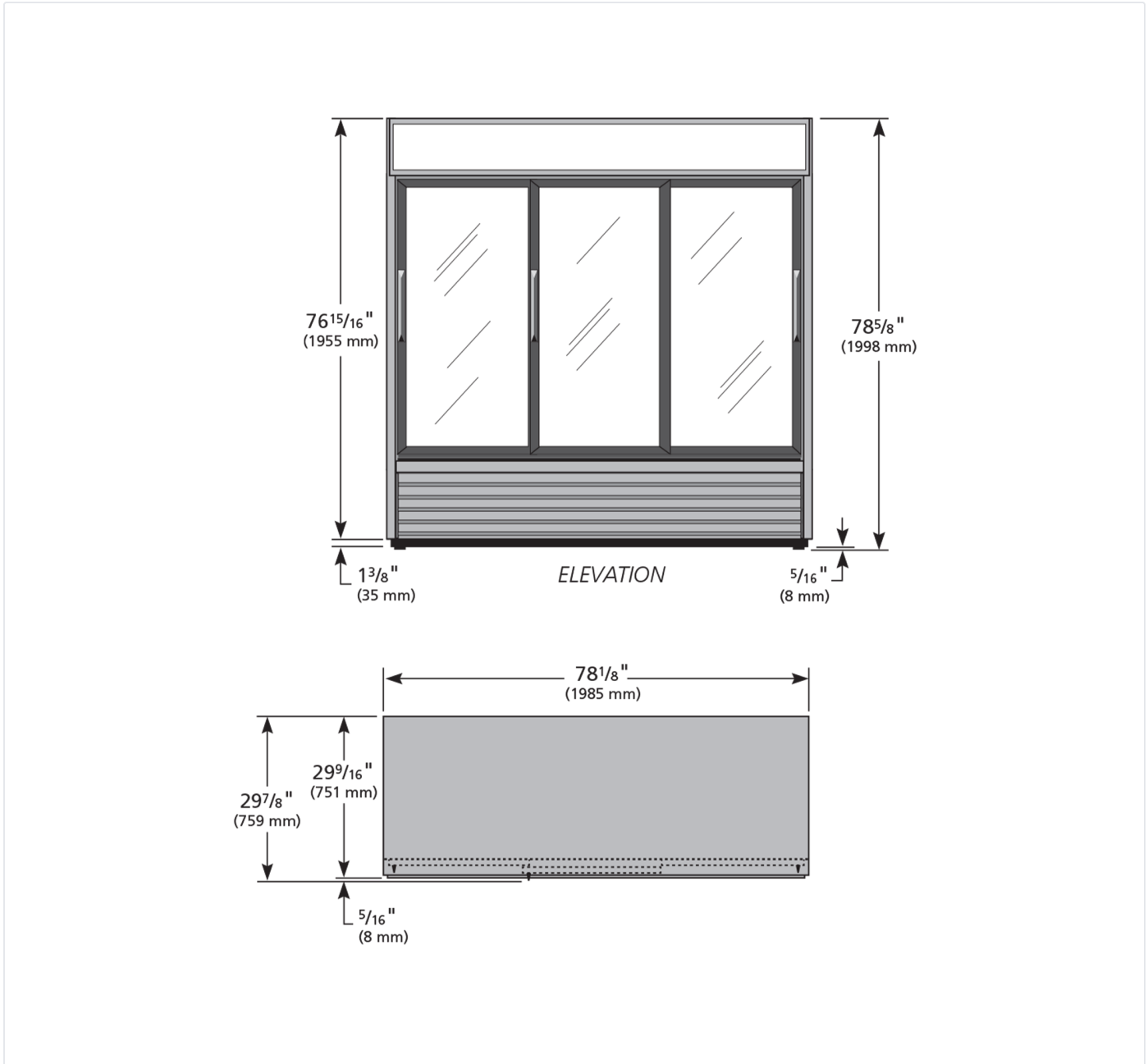

Specifications subject to change without notice.
Chart dimensions rounded up to the next whole millimeter (inches rounded up to the 1/8")

UK & Ireland
EMEA
Australia

0800 783 2049
[+41 61 563 07 05](tel:+41615630705)
[+61 2 9619 9999](tel:+61296199999)

TFIUK@truemfg.com
TrueCHCustomerService@truemfg.com
TrueRefAus@truemfg.com

